

Getting Started:

- First login to BizChannel@CIMB, please ensure you have received the following information and items:

NO	BizChannel@CIMB PACKAGE	ITEM	INFORMATION INCLUDED/ ACTION REQUIRED
1	LITE/Standard/Customised	1st email 'BizChannel@CIMB Login Details' from mybusinesscare@cimb.com	Company ID and User ID
2	LITE/Standard/Customised	2nd email 'BizChannel@CIMB User Password' from mybusinesscare@cimb.com	Password-protected file containing User Password
3	LITE/Standard/Customised	SMS from CIMB	PIN to open the password-protected file attached in the 2nd email
4	Only for Standard/Customised	^Security device (delivered to your mailing address*)	Set up PIN in your security device by following instructions provided in the device box

^ Applicable to System Administrators and/or Authorisers only.

- If you have not received the above information or item, please contact Business Call Centre at 1300 888 828 or email to mybusinesscare@cimb.com
- Note: Fields marked with asterisk (*) in the sections below are mandatory fields.

Section 1: Login to BizChannel@CIMB

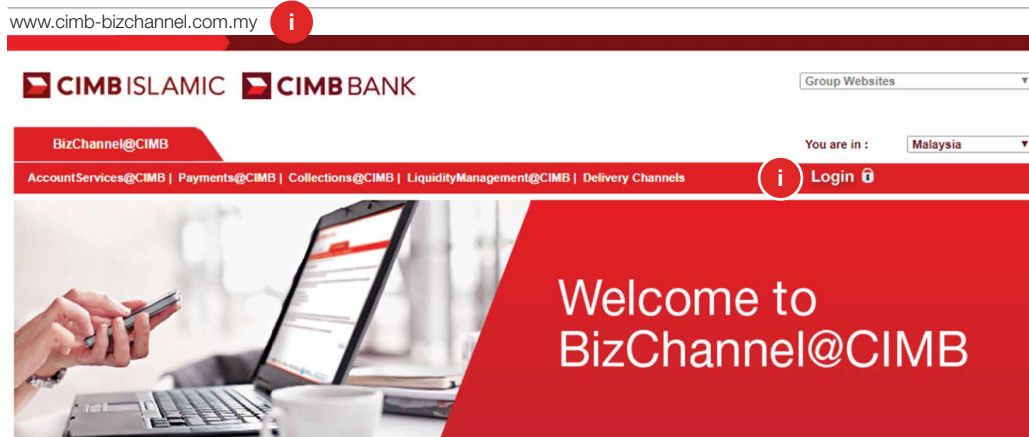

- Log on to **www.cimb-bizchannel.com.my** website and click '**Login**'.
- Click '**First Time Login**'.
- Enter the details received from 1st email 'BizChannel@CIMB Login Details' and click '**Next**'.
- Enter '**Current User Password**' retrieved from 2nd email 'BizChannel@CIMB User Password' and click '**Next**'.

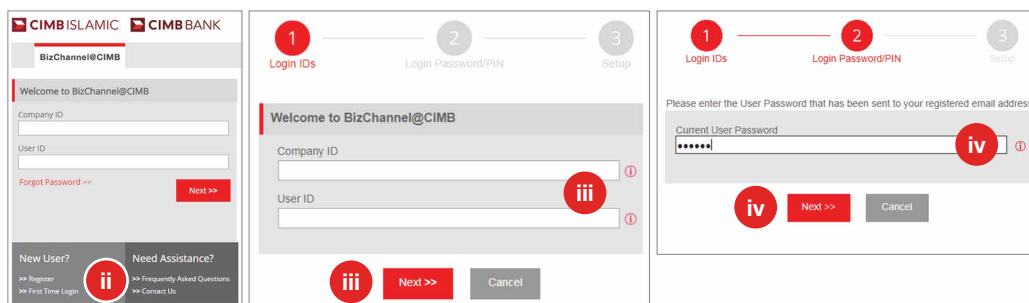

Section 2: First Time Login Setup

For all LITE Package users and maker role of Standard/Customised Package:

1 Login IDs — 2 Login PIN — 3 Setup

User Password

New User Password* ⓘ i

Confirm New User Password*

Security Questions

Security Question 1* v

Answer* ii

Security Question 2* v

Answer*

SecureWord

SecureWord* ⓘ iii

Confirm SecureWord*

*Mandatory fields

iv

- i) Enter and confirm '**New User Password**'. Password must be 8 to 10 alphanumeric characters. No special characters.
- ii) Complete the two security questions.
- iii) Enter and confirm '**SecureWord**'. SecureWord must be:
 - Alphabets/numeric/combination of both.
 - 4 to 10 characters without space or any special character.
- iv) Click '**Submit**' to complete setup.

Congratulations! You have performed your first time login successfully.

For System Administrators/Authorisers of Standard/Customised Package:

The screenshot shows a multi-step setup form with the following sections:

- Step 1: Login IDs** (indicated by a red circle with '1')
- Step 2: Login Password/PIN** (indicated by a red circle with '2')
- Step 3: Setup** (indicated by a red circle with '3')

The form sections are:

- User Password:** Fields for 'New User Password*' and 'Confirm New User Password*'. A red circle with 'i' is next to the first field.
- Authentication Device:** Fields for 'Serial Number*', '(a) Challenge' (with value 458193), and '(b) Response*'. Red circles with 'ii' and 'iv' are next to the Serial Number and Response fields respectively.
- Security Questions:** Two questions, both with the text 'What was your childhood nickname?'. Fields for 'Answer*' are provided. A red circle with 'v' is next to the second answer field.
- SecureWord:** Fields for 'SecureWord*' and 'Confirm SecureWord*'. A red circle with 'vi' is next to the first field.

At the bottom, there is a red circle with 'vii' next to a 'Submit' button, and a 'Cancel' button. A note '*Mandatory fields' is present.



- i) Enter and confirm '**New User Password**'. Password must be 8 to 10 alphanumeric characters. No special characters.
- ii) Enter the Serial Number without dash '-' (refer to the left bottom section on the back of your security device).
- iii) Security device to generate the Response Number:
 - Press and hold button followed by pressing button to switch on the device.
 - Enter the 6-digit PIN.
 - Press '2' when '**APPLI**' is displayed on screen.
 - Enter the 'Challenge Number' (a) in your security device.
- iv) Enter the 'Response Number' displayed on the security device into the 'Response' field (b).
- v) Complete the two security questions.
- vi) Enter and confirm '**SecureWord**'. SecureWord must be:
 - Alphabets/numeric/combination of both.
 - 4 to 10 characters without space or any special character.
- vii) Click '**Submit**' to complete setup.

Congratulations! You have performed your first time login successfully.

For further enquiries, please contact our Business Call Centre at **1300 888 828** between 7AM to 7PM from Monday to Friday or 8AM to 5PM on Saturday (excluding public holidays) or email to **mybusinesscare@cimb.com**.